

Location and Elev. of a small brick drain running E & W across Washington Ave at Sta 111+75[±]. (Bet 24th & 25th Sts.)

Elev = 4301.38 taken on top of brick drain 15 ft West of Center of Washington Ave

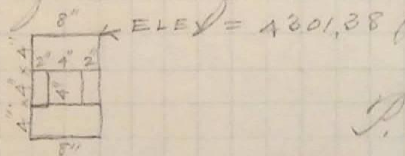

P. M., Mar 18-91

Location and Elev. of New 6" Water Pipe running E & W across Washington Ave, at Sta 114+47. (Bet 24th and 25th Sts.)

Elev = 4305.55 taken on top of pipe 15 ft West of Center of Washington Ave.

P. M., Mar 18-91

110-190
E side
Location of Bldg. Corners on Washington Ave
24th to 25th Sts (Continued from p 19)

- | | | |
|---------|------------|-----------------------------|
| 112+78 | N. side | Wagon Shed Bldg (Frame) |
| 112+98 | W " | Bank Exchange (Brick) |
| 113+115 | S " | Knitting & Cool (Frame) |
| 113+170 | S. side of | Seaman Bldg. (Brick) |
| 113+438 | N. side | Millinery Hall, W. (Frame) |
| 113+535 | S. side | City Bank |
| 113+793 | W. " | " " |
| 113+793 | E side | Elden Syle |
| 114+023 | W " | " " |
| 114+088 | S " | Hall W. R. E. Office (2436) |
| 114+293 | W " | " " |
| 114+584 | W. " | Commercial Pub Co (B) |
| 114+795 | W. " | Utah Nat Bank. (B) |